

CITY OF BALTIMORE DEPARTMENT OF RECREATION AND PARKS

NORTH HARFORD PARK PLAYGROUND AND FIELD IMPROVEMENTS STORMWATER MANAGEMENT FINAL DESIGN PLAN

RP CONTRACT #24814

BCNR # 11155

EPLANS # BCCM-25-000997



01.24.2025

Sheet List Table

Sheet Number	Sheet Title
C-100	SWM COVER SHEET
C-101	EXISTING CONDITIONS PLAN
C-102	SITE DEMOLITION PLAN
C-103	GEO-TECHNICAL BORING LOGS I
C-104	GEO-TECHNICAL BORING LOGS II
C-105	GRAVING & STAKEOUT PLAN
C-106	GRAVING PLAN DETAIL I
C-107	GRAVING PLAN DETAIL II
C-108	GRAVING & STAKEOUT TABLES
C-200	STORM DRAIN PLAN
C-201	STORM DRAIN PROFILE I
C-202	STORM DRAIN PROFILE II
C-203	STORM DRAIN PROFILES III
C-204	STORM DRAIN DETAILS
C-205	WATER & SANITARY UTILITY PLAN
C-300	SWM PLAN & ESD DRAINAGE AREA MAP
C-301	SWM NOTES AND SPECIFICATIONS
C-302	SWM PLAN DETAIL 1
C-303	SWM PLAN DETAIL 2
C-304	SWM DETAILS
C-305	QUANTITY DRAINAGE AREA MAP
C-400	STAGE 1 ESC PLAN
C-401	STAGE 2 INITIAL ESC PLAN
C-402	STAGE 2 FINAL ESC PLAN
C-403	EROSION & SEDIMENT CONTROL NOTES I
C-404	EROSION & SEDIMENT CONTROL NOTES II
C-405	GRADING PROFILES
C-406	EROSION & SEDIMENT CONTROL DETAILS I
C-407	EROSION & SEDIMENT CONTROL DETAILS II

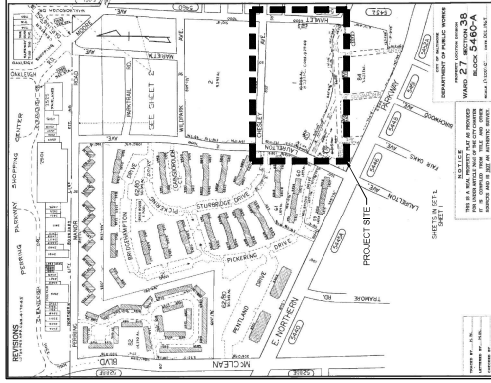

PROPERTY MAP SCALE: 1" = 400'

PROJECT INFORMATION: DEPARTMENT OF RECREATION AND PARKS
ADDRESS: 6800 HAMLET AVENUE, BALTIMORE, MD 21284
WATERSHED: BACK RIVER 02139K21
WARD: 27 SECTION: 36
ZONING: OPEN SPACE (OS)

EARTHWORK TABULATION	
DISTURBED AREA:	820 AC (270,121 SF)
TOTAL CUT:	3,146 CY
TOTAL FILL:	7,064 CY
NET FILL MATERIAL:	3,308 CY
CUT/FILL RATIO:	1:1.3

- NOTES:
- DATA IS APPROXIMATE AND IS PROVIDED FOR BALTIMORE CITY REVIEW AND FOR THE CONTRACTOR TO VERIFY DATA AND NOTIFY ENGINEER OF ANY DISCREPANCIES.
 - A PORTION OF THE EXCAVATED CUT EARTHWORK MATERIAL SHALL BE USED AS BACKFILL.

OWNER'S CERTIFICATION
I HEREBY CERTIFY THAT THIS PLAN HAS BEEN PREPARED BY ME OR UNDER MY SUPERVISION AND MEETS THE MINIMUM STANDARDS OF BALTIMORE CITY DEPARTMENT OF PUBLIC WORKS REQUIREMENTS AND PROFESSIONAL STANDARDS.

DESIGNED: Adam Boardman
ADDRESS: 2800 Madison Ave
SIGNATURE: [Signature]
DATE: 02/21/25
TELEPHONE NUMBER: 410-396-7948

ENGINEER'S CERTIFICATION
I HEREBY CERTIFY THAT THIS PLAN HAS BEEN PREPARED BY ME OR UNDER MY SUPERVISION AND MEETS THE MINIMUM STANDARDS OF BALTIMORE CITY DEPARTMENT OF PUBLIC WORKS REQUIREMENTS AND PROFESSIONAL STANDARDS.

DESIGNED: Ronald S. Rudisill
ADDRESS: 2900 Marlinton Ave
SIGNATURE: [Signature]
DATE: 02/21/25
TELEPHONE NUMBER: 410-396-7948

CONTRACTOR'S CERTIFICATION
I HEREBY CERTIFY THAT THE CONTRACTOR HAS REVIEWED THE PLAN AND HAS CONDUCTED AS SHOWN ON THE PLAN. I UNDERSTAND THAT THE CONTRACTOR SHALL BE RESPONSIBLE FOR THE PROPER CONSTRUCTION OF ANY WORK SHOWN ON THIS PLAN AND SHALL BE RESPONSIBLE FOR THE PROPER MAINTENANCE OF THE STORMWATER MANAGEMENT FACILITY AND OPERATIONAL FACILITY.

CONTRACTOR'S NAME: [Name]
ADDRESS: [Address]
SIGNATURE: [Signature]
DATE: 01.24.2025
TELEPHONE NUMBER: [Number]

AVED
Environmental Services
Stormwater Management (DPW)
Erosion and Sediment Control (BCNR)
City of Baltimore
Project ID: BCNR-11155
Approved Date: 1/23/2025

NORTH HARFORD PARK
6800 HAMLET AVE
BALTIMORE, MD 21284
WARD 27 SECTION 36
BLOCK 5460A, LOT 001
Landscape Architect

JONATHAN CECI
LANDSCAPE ARCHITECTS
1400 North Avenue, #102
Baltimore, Maryland 21202
www.jonathanceci.com
410-291-8059

CITYSCAPE ENGINEERING, LLC
3600 Clippert Mill Road, Suite 214
Baltimore, MD 21211
Structural Engineer

COLUMBA ENGINEERING, INC
1400 North Avenue, Suite 150
Columbia, MD 21046
Electrical and Plumbing Engineer

KES ENGINEERING, INC.
6325 Woodside Ct., Suite 220
Columbia, MD 20146

MAJOR CONSULTANTS
QUANTIC STRUCTURES INTERNATIONAL
7900 TransCanada Pkwy.
Pointe-Claire Quebec, Canada
Civil Engineer

FORELGA GROUP
5180 Parkstone Drive, Suite 250
Chantilly, VA 20151-5812
Civil Engineer

BALTIMORE CITY DEPARTMENT OF RECREATION AND PARKS
Capital Development and Planning
Martha Sam, Design Planner 1.410.546.3339

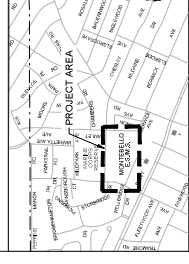

NO.	REVISION	BY	DATE
1			
2			
3			
4			
5			

DESIGNED: DRAWN: CHECKED:

BALTIMORE CITY DEPARTMENT OF PUBLIC WORKS
Professional Engineer Under the Laws of the State of Maryland
Ronald S. Rudisill
BAC DATE: 06/19/2027

OWNER #	11155	EPLAN #	BCCM-25-000997
RP #	24814	DATE	05.29.2025
SHEET TITLE			
SWM COVER SHEET			
DWG. NO.:			
C-100			