

CAUTION: IF THIS DRAWING IS A REDUCTION,
GRAPHIC SCALE MUST BE USED
(ORIGINAL SIZE = 24" x 36")
GRAPHIC SCALE

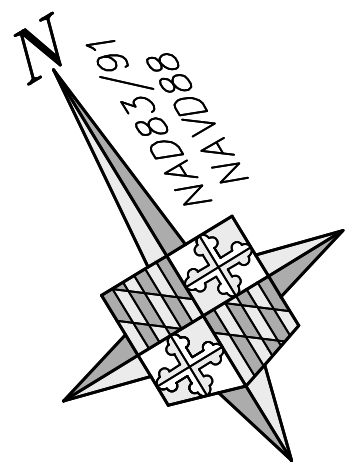
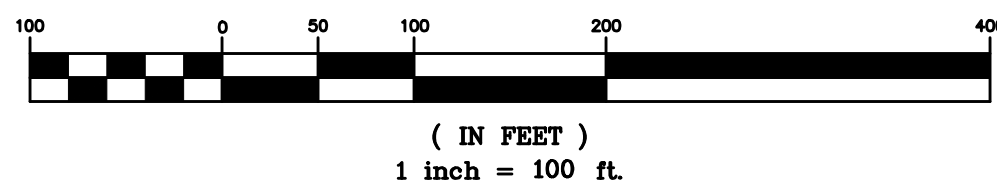

STANDARD STABILIZATION NOTE

FOLLOWING INITIAL SOIL DISTURBANCE OR RE-DISTURBANCE, PERMANENT OR TEMPORARY STABILIZATION MUST BE COMPLETED WITHIN:

- A. THREE (3) CALENDAR DAYS AS TO THE SURFACE OF ALL PERIMETER DIKES, SWALES, DITCHES, PERIMETER SLOPES, AND ALL SLOPES STEEPER THAN 3 HORIZONTAL TO 1 VERTICAL (3:1); AND
- B. SEVEN (7) CALENDAR DAYS AS TO ALL OTHER DISTURBED OR GRADED AREAS ON PROJECT SITE NOT UNDER ACTIVE GRADING.

STOCKPILE NOTES

- 1. NO STOCKPILING ALLOWED ON ASPHALT.
- 2. ALL STOCKPILES LEFT AT THE END OF THE DAY NEED TO BE STABILIZED UNTIL THE NEXT REDISTURBANCE.

UTILITY NOTE FOR SECONDARY UTILITY WORK

- A. ALL DISTURBANCE FROM SECONDARY UTILITIES SUCH AS PHONE CABLE, ELECTRIC CABLE, T.V. CABLE, ETC. WILL BE SUBCONTRACTORS RESPONSIBILITY TO BRING WORK AREA BACK TO GRADE LEVEL THAT WAS EXISTING AND SEED AND MULCH AND DISTURBANCE FROM INSTALLATION OF LINES OR CONDUIT.
- B. SUB CONTRACTOR WILL BE RESPONSIBLE FOR RE-INSTALLING OR REPAIRING ANY SILT FENCE OR SEDIMENT CONTROLS THAT WERE EXISTING TO MAINTAIN PROPER SEDIMENT CONTROL THAT MIGHT HAVE BEEN DAMAGED.

FOR UTILITY WORK ONLY OR OFF-SITE UTILITY WORK

- 1. DISTURBANCE OUTSIDE OF LOD CANNOT EXCEED 5000 SQUARE FEET.
- 2. PLACE ALL EXCAVATED MATERIAL ON HIGH SIDE OF TRENCH.
- 3. ONLY DO AS MUCH WORK AS CAN BE DONE IN ONE DAY SO BACKFILLING, FINAL GRADING, SEEDING AND MULCHING CAN OCCUR.
- 4. ANY SEDIMENT CONTROL MEASURES DISTURBED BY CONSTRUCTION WILL BE REPAIRED THE SAME DAY.

"MISS UTILITY"

CONTRACTOR TO NOTIFY "MISS UTILITY" AT (800) 257-7777 AND THE CITY OF FREDERICK DEPARTMENT OF ENGINEERING AT (301) 600-1405 AT LEAST 72 HOURS PRIOR TO START OF CONSTRUCTION. THE EXCAVATOR MUST NOTIFY ALL PUBLIC UTILITY COMPANIES WITH UNDERGROUND FACILITIES IN THE AREA OF PROPOSED EXCAVATION AND HAVE THOSE FACILITIES LOCATED BY THE UTILITY COMPANIES PRIOR TO COMMENCING EXCAVATION. BEFORE EXCAVATION THE CONTRACTOR IS RESPONSIBLE FOR CALLING TICKET CHECK AT 1-866-821-4226 TO VERIFY THAT ALL UTILITIES HAVE BEEN MARKED, 72 HOURS AFTER CALLING "MISS UTILITY".

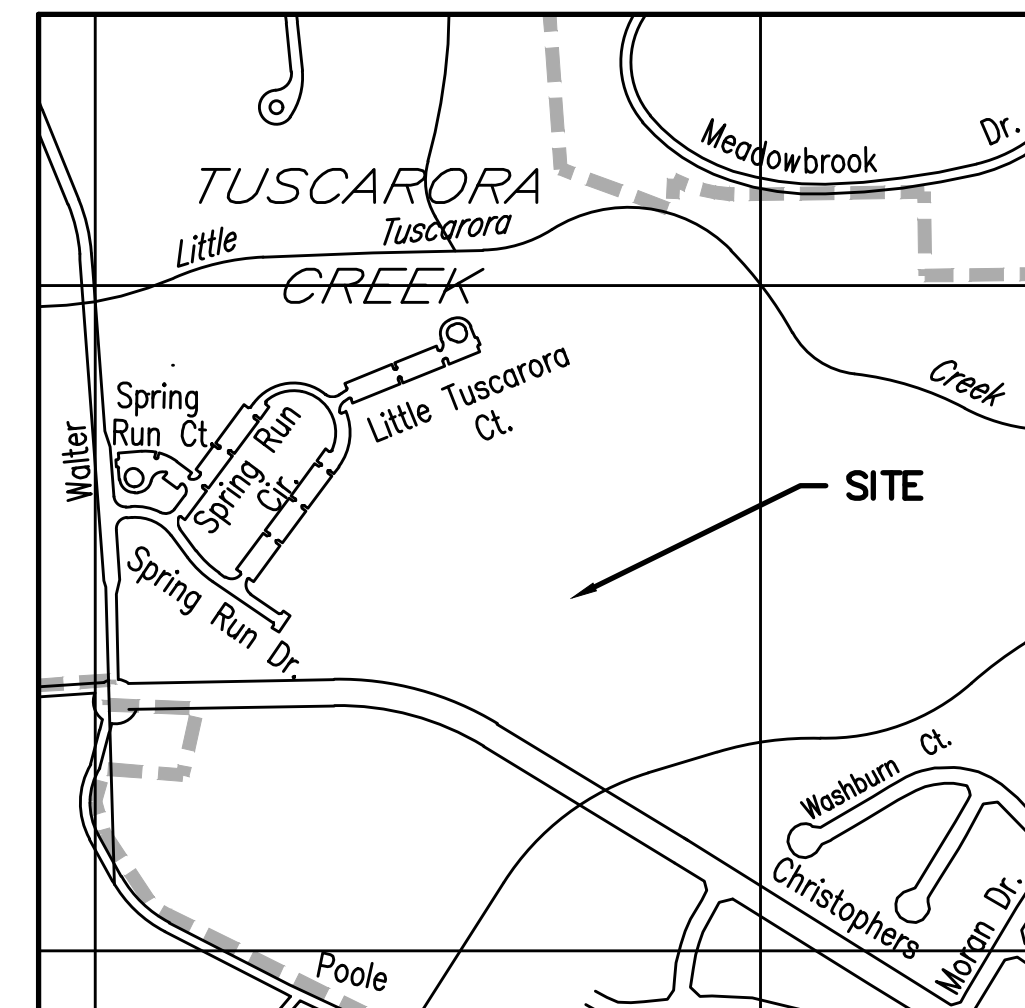
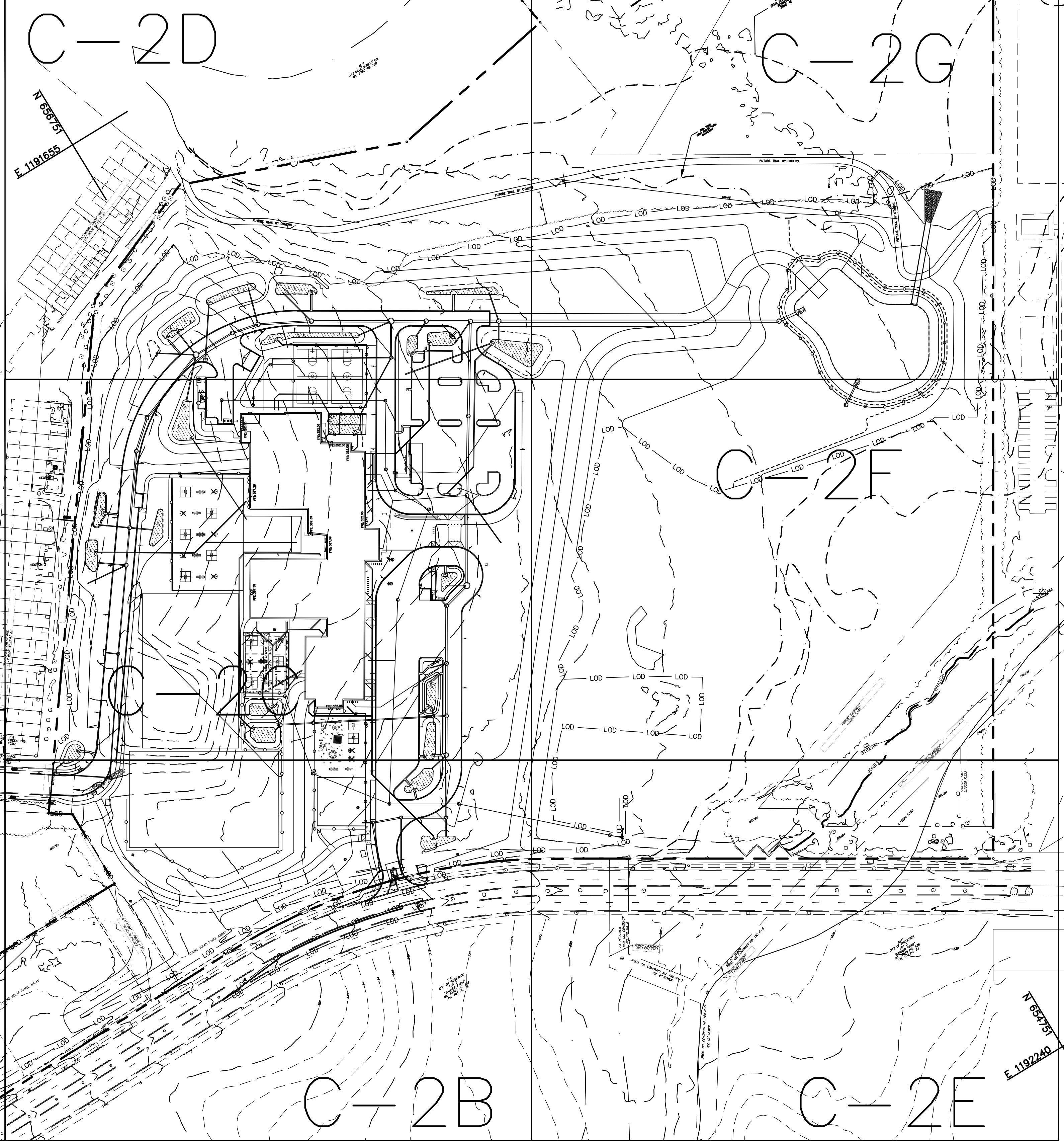

LOCATION MAP
SCALE: 1" = 600'
CITY OF FREDERICK STREET MAP
GRID: H-0
ADC MAP 21 D9

SEDIMENT & EROSION CONTROL NOTES

1. ALL EROSION/SEDIMENT CONTROL MEASURES SHALL COMPLY WITH THE "MARYLAND STANDARDS AND SPECIFICATIONS FOR SOIL EROSION AND SEDIMENT CONTROL" AS APPROVED BY THE COUNTY.
2. ALL DISTURBED AREAS NOT UNDER ACTIVE GRADING TO BE SEEDED WITHIN 7 DAYS OF INITIAL GRADING. FOR TEMPORARY SEEDING SPECIFICATIONS, SEE SECTION B1 "2011 MARYLAND STANDARDS AND SPECIFICATIONS FOR SOIL EROSION AND SEDIMENT CONTROL" PUBLISHED JOINTLY BY WATER RESOURCES ADMINISTRATION, SOIL CONSERVATION SERVICE, AND THE STATE SOIL CONSERVATION COMMITTEE.
3. ALL EROSION AND SEDIMENT CONTROL MEASURES ARE TO BE PLACED PRIOR TO OR AT THE INITIATION OF GRADING.
4. ALL STORM DRAIN AND SANITARY SEWER LINES NOT IN PAVED AREAS AND NOT SUBJECT TO ACTIVE GRADING ARE TO BE MULCHED & SEEDED WITHIN 7 DAYS AFTER INITIAL BACKFILL.
5. ELECTRIC POWER, TELEPHONE AND GAS LINES NOT IN ACTIVE GRADING AREAS ARE TO BE COMPACTED, SEEDED AND MULCHED WITHIN 7 DAYS AFTER INITIAL BACKFILL.
6. ALL EARTH BERMS AND SEDIMENT DAMS ARE TO BE MULCHED AND SEEDED (SEE SECTION B OF ABOVE REFERENCE) WITHIN 7 DAYS AFTER GRADING. ALL SOIL STOCKPILES ARE TO BE MULCHED AND SEEDED WITHIN 7 DAYS.
7. DURING CONSTRUCTION, ALL SEDIMENT CONTROL STRUCTURES WILL BE INSPECTED AFTER EACH RAINFALL AND REPAIRED IF NECESSARY. SEDIMENT TO BE REMOVED TO A SUITABLE DISPOSAL AREA AND STABILIZED WITH PERMANENT VEGETATIVE COVER. (SEE SECTION B OF "2011 MARYLAND STANDARDS AND SPECIFICATIONS FOR SOIL EROSION AND SEDIMENT CONTROL" PUBLISHED JOINTLY BY WATER MANAGEMENT ADMINISTRATION, SOIL CONSERVATION SERVICE AND STATE SOIL CONSERVATION COMMITTEE).
8. CONTRACTOR IS RESPONSIBLE FOR MAINTAINING ALL SEDIMENT EROSION CONTROL MEASURES UNTIL DISTURBED AREAS ARE STABILIZED.
9. AFTER FINE GRADING, ALL DISTURBED AREAS ARE TO BE PERMANENTLY MULCHED AND SEEDED. (SEE SECTION B)
10. NO SLOPE SHALL BE GREATER THAN 2:1.
11. FOLLOWING INITIAL SOIL DISTURBANCE OR REDISTURBANCE, PERMANENT OR TEMPORARY STABILIZATION SHALL BE COMPLETED WITHIN THREE (3) CALENDAR DAYS AS TO THE SURFACE OF ALL PERIMETER CONTROLS, DIKES, SWALES, DITCHES, PERIMETER SLOPES, AND ALL SLOPES GREATER THAN 3 HORIZONTAL TO 1 VERTICAL (3:1); AND SEVEN (7) DAYS AS TO ALL OTHER DISTURBED OR GRADED AREAS ON THE PROJECT SITE. THIS DOES NOT APPLY TO THOSE AREAS WHICH ARE SHOWN ON THE PLAN AND ARE CURRENTLY BEING USED FOR MATERIAL STORAGE OR FOR THOSE AREAS ON WHICH ACTUAL CONSTRUCTION ACTIVITIES ARE CURRENTLY BEING PERFORMED. MAINTENANCE SHALL BE PERFORMED AS NECESSARY TO ENSURE THAT STABILIZED AREAS CONTINUOUSLY MEET THE APPROPRIATE REQUIREMENTS OF THE "2011 MARYLAND STANDARDS AND SPECIFICATIONS FOR SOIL EROSION AND SEDIMENT CONTROL".
12. ALL EROSION AND SEDIMENT CONTROL MEASURES SHALL BE INSTALLED AND MAINTAINED IN CONTINUOUS COMPLIANCE WITH THE LATEST VERSION OF THE MARYLAND STANDARDS AND SPECIFICATIONS FOR SOIL EROSION AND SEDIMENT CONTROL.
13. ALL UTILITIES SUCH AS STORM DRAIN, PUBLIC WATER, SANITARY SEWER, ELECTRIC POWER, TELEPHONE CABLE AND GAS LINES, THAT ARE NOT IN PAVED AREAS AND ARE NOT UNDERGOING ACTIVE GRADING SHALL BE TEMPORARILY OR PERMANENTLY STABILIZED WITHIN 3 DAYS OF INITIAL DISTURBANCE.
14. THE OWNER DEVELOPER OR THEIR DESIGNATEE IS RESPONSIBLE FOR CONDUCTING ROUTINE MAINTENANCE. THE SITE AND CONTROLS SHOULD BE INSPECTED WEEKLY AND THE NEXT DAY AFTER EACH RAIN EVENT. ANY ACCUMULATED SEDIMENT SHALL BE REMOVED AND DISPOSED OF IN A SUITABLE AREA AND SHALL BE TEMPORARILY OR PERMANENTLY STABILIZED.

** ANY PROJECT THAT HAS A STATE ISSUED N.O.I. PERMIT MUST DOCUMENT EACH INSPECTION AND MAINTAIN AN INSPECTION LOG (PLEASE SEE NOI FOR DETAILS)

Frederick County Soil Conservation District
Erosion and Sediment Control Plan Approval

BY: _____
District Manager or Designee

DATE: _____
Plan is valid for 2 years from date of approval

S.C.D. approval for sediment and erosion control is in accordance with the 2011 Maryland Standards and Specification for Soil Erosion and Sediment Control and is contingent upon issuance of all applicable regulatory permit.

SEL ARCHITECTS
SMILEN • EMR
1811 Corporate Blvd, Suite 340
Rockville, Maryland 20850
Phone: 301-770-0177 Fax: 301-530-3224
www.selarch.com

ADTEK
CIVIL, STRUCTURAL, AND SPECIALTY ENGINEERING
150 South East Street, Suite 301
Phone: 301-462-4408 Fax: 301-662-7484
www.adtekgreens.com

NO.	DATE	ISSUE	DESCRIPTION

APPLICANT
FREDERICK COUNTY PUBLIC SCHOOLS
ATTN: BRIAN STAIGER
110 THOMAS JOHNSON DR.
SUITE 210
FREDERICK, MARYLAND 20701
240.586.8456
BRIAN.STAIGER@CPS.ORG

PC24-74FSI

YELLOW SPRINGS ELEMENTARY SCHOOL
CHRISTOPHERS CROSSING FREDERICK, MD 21702
MAP: 067A GRID: 17 PARCEL: 1801 NEIGHBORHOOD: 2040028.11
SUBDIVISION: 0000 SECTION: N/A BLOCK: N/A
LOT: 1S-A PLAT BOOK & PAGE 109/74, ELECTION DISTRICT: 08

EROSION AND SEDIMENT CONTROL PLAN

SCALE: 1" = 100'

DATE: 12/06/2024

PROJECT NUMBER: 2077.0001

DRAWN BY: AMN DESIGN BY: AMN CHECKED BY: SPB DRAWING NUMBER: C-2